

2024 HARVEST EQUIPMENT

# DEMCO



**Don't miss our new**

**High Speed All Wheel Steer Header Transport!** pg18

**GRAIN CARTS**  
DUAL AUGER  
1100-2200



**GRAIN CARTS**  
SINGLE AUGER  
850-1300



**GRAIN WAGONS**  
500-750



**HEADER TRANSPORTS**



**GRAIN TANK EXTENSIONS & TIP-UPS**



**AUGERS & EXTENDERS**



# DUAL AUGER GRAIN CARTS

**1700 DA**  
**2200 DA**



## BUSHEL CAPACITY

	1700	2200
Level Full	1750	2200
Heaped	1900	2350

*Bushel capacity measured with #2 corn at 15% moisture content (56 lb. test weight)*

*Demco's own forward reach and height adjust unloading auger!*

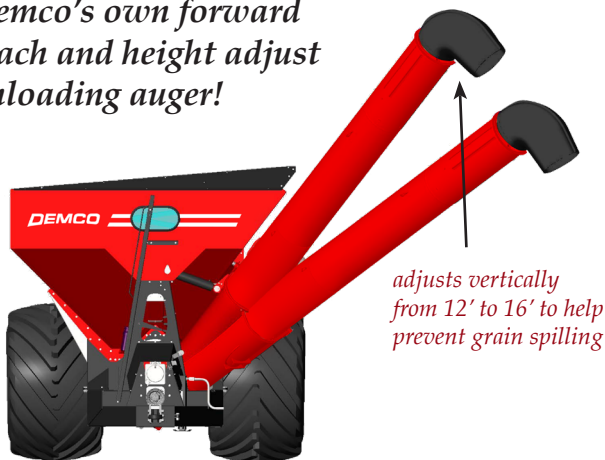

*adjusts vertically from 12' to 16' to help prevent grain spilling*

COLORS AVAILABLE:



## STANDARD FEATURES

- 1 3/4 - 1000 RPM PTO
- **Protect auger driver and tractor PTO** with the automatic reset "cut-out" clutch with overrunning clutch
- **NO Pulleys or Belts!** PTO driven drivetrain. Gearbox includes 2 output PTO shafts (1 for horizontal auger and 1 for vertical auger).
- Adjustable austempered cast hitch, fits category 4 or 5 hammer strap tractor drawbar
- Grain viewing windows
- 10,000 lb. drop-leg tongue jack with separate storage position **provides tighter turning radius**
- Hand wheel operated clean-out door at bottom of auger for **easy post season clean-out**
- **High visibility** - reflective decals & LED lights
- **Narrow transport width** - 14'
- **Better clearance** - low side cart height **ONLY 11'1" (1700) and 11'8" (2200)**
- Low center of gravity for **side hill stability**
- 6 lever operated doors for trough clean-out
- Backlit ergonomic pendant (requires 1 remote outlet)
- Roll tarp
- 5-point scale system (monitor not included)

## DUAL AUGERS

- 22" diameter vertical auger with 3/8" flighting and Posi-Drive connection
- 20" horizontal drag auger
- UltraFlyte made with 1008/1010 high carbon steel including a thicker outer edge, resulting in up to 50% longer wear and faster conveying
- Forward reach auger for optimum operator visibility - adjusts vertically from 12' to 16' to help prevent grain spilling
- Auger folds within the width of the box for compact transporting and storage
- 2 stage unload auger folding cylinder

## OPTIONS

- Electric roll tarp
- Auto gate shutoff for drag auger doors (requires the Libra Cart Wireless Scale)
- Hydraulic Jack





*NOTE: Demco grain carts are not to be towed down the road loaded*

**HOW TO ORDER:** 1. Choose **Model** 2. Choose **Color** 3. Choose **Undercarriage Type** 4. Review **Accessories**

**MODEL**

*\* All grain carts require a Demco axle*

<b>1700</b> Grain Cart - Gray	<b>9445311</b>	\$109,153.00
<b>1700</b> Grain Cart - Red	<b>9445308</b>	\$109,153.00
<b>1700</b> Grain Cart - Green	<b>9445309</b>	\$109,153.00
<b>2200</b> Grain Cart - Gray	<b>9445315</b>	\$125,495.00
<b>2200</b> Grain Cart - Red	<b>9445312</b>	\$125,495.00
<b>2200</b> Grain Cart - Green	<b>9445313</b>	\$125,495.00

**UNDERCARRIAGE with 5 POINT SCALE**

<b>1700</b> Grain Cart - Tandem Axle - 900/60/R32 - 10 Bolt Hub	<b>9445464</b>	\$89,308.00
<b>2200</b> Grain Cart - Tandem Axle - 1050/50R/ 32 - 10 Bolt Hub	<b>9445463</b>	\$102,677.00
<b>1700</b> Axle with Tracks		Call for Price and Availability
<b>2200</b> Axle with Tracks		Call for Price and Availability

**FACTORY INSTALLED ACCESSORIES**

Cat 4 Bull-Pull Hitch™ (I.L.O. Cast Hitch)	<b>9440125</b>	\$461.00
Cat 5 Bull-Pull Hitch™ (I.L.O. Cast Hitch)	<b>9440127</b>	\$692.00
Electric Roll Tarp Kit	<b>9440157</b>	\$4,750.00
Hydraulic Jack	<b>9445616</b>	\$1,241.00

**FIELD INSTALLED ACCESSORIES**

Cat 4 Bull-Pull Hitch™	<b>9440126</b>	\$864.00
Cat 5 Bull-Pull Hitch™	<b>9440128</b>	\$1,094.00
Electric Roll Tarp Kit	<b>9440150</b>	\$5,414.00
Hydraulic Jack	<b>9445617</b>	\$1,522.00

**ACCESSORIES**

640 Console with harnesses	<b>9440111</b>	\$1,478.00
2060 Console with harnesses	<b>9440116</b>	\$2,803.00
ISO Bus ECU with harnesses	<b>9440131</b>	\$4,949.00
Wireless Scale <b>Libra Cart</b> *	<b>9440177</b>	\$3,152.00
Wireless Scale <b>Libra Cart</b> w/ Auto Gate Shutoff*	<b>9440149</b>	\$4,919.00
12 VDC Printer with interface cable	<b>14990</b>	\$1,102.00
Fire Suppression Kit	<b>9440182</b>	\$5,380.00

*\* Libra Cart is Android and Apple compatible*

# DUAL AUGER GRAIN CARTS

## 1500 DA

### BUSHEL CAPACITY

	<u>1500</u>
Level Full	1500
Heaped	

Bushel capacity measured with #2 corn at 15% moisture content (56 lb. test weight)



**NEW**  
in 2024

- ◀ DEMCO's newest Dual Auger Grain Cart design is available in **RIGHT SIDE or LEFT SIDE** unloading auger positions. The **NEW FRONT FOLDING AUGER** design allows us to maintain low clearance on both sides of the grain cart.
- ◀ These carts will maintain our corner auger design that gives the grain cart operator optimal visibility while unloading grain
- ◀ Demco grain carts are tough and reliable and help make our harvest operation productive and smooth
- ◀ Available on ALL Dual Auger Models in 2024 including the new 1500 Dual Auger Grain Cart

COLORS AVAILABLE:



### STANDARD FEATURES

- 1 3/4 - 1000 RPM PTO
- **Protect auger driver and tractor PTO** with the automatic reset "cut-out" clutch with overrunning clutch
- **NO Pulleys or Belts!** PTO driven drivetrain. Gearbox includes 2 output PTO shafts (1 for horizontal auger and 1 for vertical auger).
- Adjustable austempered cast hitch, fits category 4 or 5 hammer strap tractor drawbar
- Grain viewing windows
- 10,000 lb. drop-leg tongue jack with separate storage position **provides tighter turning radius**
- Hand wheel operated clean-out door at bottom of auger for **easy post season clean-out**
- **High visibility** - reflective decals & LED lights
- **Narrow transport width** - 14'
- **Better clearance** - low side cart height
- Low center of gravity for **side hill stability**
- 6 lever operated doors for trough clean-out
- Backlit ergonomic pendant (requires 1 remote outlet)
- Roll tarp
- 5-point scale system (monitor not included)

### DUAL AUGERS

- 22" diameter vertical auger with 3/8" flighting and Posi-Drive connection
- 20" horizontal drag auger
- UltraFlyte made with 1008/1010 high carbon steel including a thicker outer edge, resulting in up to 50% longer wear and faster conveying
- Forward reach auger for optimum operator visibility - adjusts vertically from 12' to 16' to help prevent grain spilling
- Auger folds within the width of the box for compact transporting and storage
- 2 stage unload auger folding cylinder

### OPTIONS

- Camso Track Systems - 100 Series, 36" Wide Belt
- Soucy Track Systems - 36" Wide Belt
- Electric roll tarp
- Auto gate shutoff for drag auger doors (requires the Libra Cart Wireless Scale)
- Hydraulic Jack





*NOTE: Demco grain carts are not to be towed down the road loaded*

**HOW TO ORDER:** 1. Choose **Model** 2. Choose **Color** 3. Choose **Undercarriage Type** 4. Review **Accessories**

**MODEL**

*\* All grain carts require a Demco axle*

<b>1500</b> Grain Cart - Gray	<b>9445307</b>	Call for Pricing
<b>1500</b> Grain Cart - Red	<b>9445304</b>	Call for Pricing
<b>1500</b> Grain Cart - Green	<b>9443505</b>	Call for Pricing

**UNDERCARRIAGE with 5 POINT SCALE**

<b>1500</b> Camso Track with Axle	<b>9445456</b>	\$137,579.00
<b>1500</b> Soucy Track with Axle	<b>9445479</b>	\$137,579.00

**FACTORY INSTALLED ACCESSORIES**

Cat 4 Bull-Pull Hitch™ (I.L.O. Cast Hitch)	<b>9440125</b>	\$461.00
Cat 5 Bull-Pull Hitch™ (I.L.O. Cast Hitch)	<b>9440127</b>	\$692.00
Electric Roll Tarp Kit	<b>9440157</b>	\$4,750.00
Hydraulic Jack	<b>9445616</b>	\$1,241.00

**FIELD INSTALLED ACCESSORIES**

Cat 4 Bull-Pull Hitch™	<b>9440126</b>	\$864.00
Cat 5 Bull-Pull Hitch™	<b>9440128</b>	\$1,094.00
Electric Roll Tarp Kit	<b>9440150</b>	\$5,414.00
Hydraulic Jack	<b>9445617</b>	\$1,522.00

**ACCESSORIES**

640 Console with harnesses	<b>9440111</b>	\$1,478.00
2060 Console with harnesses	<b>9440116</b>	\$2,803.00
ISO Bus ECU with harnesses	<b>9440131</b>	\$4,949.00
Wireless Scale <b>Libra Cart</b> *	<b>9440177</b>	\$3,152.00
Wireless Scale <b>Libra Cart</b> w/ Auto Gate Shutoff*	<b>9440149</b>	\$4,919.00
12 VDC Printer with interface cable	<b>14990</b>	\$1,102.00
Fire Suppression Kit	<b>9440182</b>	\$5,380.00

*\* Libra Cart is Android and Apple compatible*

# DUAL AUGER GRAIN CARTS

**1100 DA**  
**1300 DA**

## BUSHEL CAPACITY

	1100	1300
Level Full	1150	1325
Heaped	1250	1425

*Bushel capacity measured with #2 corn at 15% moisture content (56 lb. test weight)*



**EASY TO FUNCTION IN THE DARK**

### BACKLIT PENDANT GRIP CONTROL

*Ergonomic pendant operates "1 touch" auger fold, adjustable spout, unload auger height adjust, and drag auger door*

**"PTO Driven Drivetrain"**

**"Reflective Decals"**



**"Low Profile"**

**"5 Point Scale System"**

**Demco's own forward reach and NEW height adjust unloading auger!**

**COLORS AVAILABLE:**



## STANDARD FEATURES

- 1 3/4 - 1000 RPM PTO
- **Protect auger driver and tractor PTO** with the automatic reset "cut-out" clutch with overrunning clutch
- **NO Pulleys or Belts!** PTO driven drivetrain. Gearbox includes 2 output PTO shafts (1 for horizontal auger and 1 for vertical auger).
- Adjustable austempered cast hitch, fits category 4 or 5 hammer strap tractor drawbar
- Grain viewing windows
- 10,000 lb. drop-leg tongue jack with separate storage position **provides tighter turning radius**
- Hand wheel operated clean-out door at bottom of auger for **easy post season clean-out**
- **High visibility** - reflective decals & LED lights
- **Narrow transport width** - w/ 1050 tires: 11' 9", w/ 1250 tires: 12'4"
- **Better clearance** - low side cart height ONLY 11'
- Low center of gravity for **side hill stability**
- 6 lever operated doors for trough clean-out
- Backlit ergonomic pendant (requires 1 remote outlet)
- Roll tarp
- 5-point scale system (monitor not included)

## DUAL AUGERS

- 22" diameter vertical auger with 3/8" flighting and Posi-Drive connection
- 20" horizontal drag auger
- UltraFlyte made with 1008/1010 high carbon steel including a thicker outer edge, resulting in up to 50% longer wear and faster conveying
- Forward reach auger for optimum operator visibility - adjusts vertically from 12' to 16' to help prevent grain spilling
- Auger folds within the width of the box for compact transporting and storage
- 2 stage unload auger folding cylinder

## OPTIONS

- Camso Track Systems - 100 Series, 36" Wide Belt
- Soucy Track Systems - 36" Wide Belt
- Electric roll tarp
- Auto gate shutoff for drag auger doors (requires the Libra Cart Wireless Scale)
- Hydraulic Jack





*NOTE: Demco grain carts are not to be towed down the road loaded*

**HOW TO ORDER:** 1. Choose **Model** 2. Choose **Color** 3. Choose **Undercarriage** 4. Review **Accessories**

**MODEL**

*\* All grain carts require a Demco axle*

<b>1100</b> Grain Cart - Gray	<b>9445199</b>	\$87,460.00
<b>1100</b> Grain Cart - Red	<b>9445196</b>	\$87,460.00
<b>1100</b> Grain Cart - Green	<b>9445197</b>	\$87,460.00
<b>1300</b> Grain Cart - Gray	<b>9445303</b>	\$90,216.00
<b>1300</b> Grain Cart - Red	<b>9445300</b>	\$90,216.00
<b>1300</b> Grain Cart - Green	<b>9445301</b>	\$90,216.00

**AXLE TYPE with 5 POINT SCALE**

<b>1100</b> Axle with 1050/50R32 Tires - <b>10 Bolt</b>	<b>9445453</b>	\$64,180.00
<b>1300</b> Axle with 1250/50R32 Tires - <b>20 Bolt</b>	<b>9445461</b>	\$73,125.00
Camso Track w/ Axle	<b>9445456</b>	\$137,579.00
Soucy Track w/ Axle	<b>9445479</b>	\$137,579.00

**FACTORY INSTALLED ACCESSORIES**

Cat 4 Bull-Pull Hitch™ (I.L.O. Cast Hitch)	<b>9440125</b>	\$461.00
Cat 5 Bull-Pull Hitch™ (I.L.O. Cast Hitch)	<b>9440127</b>	\$692.00
Electric Roll Tarp Kit	<b>9440156</b>	\$3,897.00
Hydraulic Jack	<b>9445616</b>	\$1,241.00

**FIELD INSTALLED ACCESSORIES**

Cat 4 Bull-Pull Hitch™	<b>9440126</b>	\$864.00
Cat 5 Bull-Pull Hitch™	<b>9440128</b>	\$1,094.00
Hydraulic Jack	<b>9445617</b>	\$1,522.00
Electric Roll Tarp Kit	<b>9440142</b>	\$3,458.00

**ACCESSORIES**

640 Console with harnesses	<b>9440111</b>	\$1,478.00
2060 Console with harnesses	<b>9440116</b>	\$2,803.00
ISO Bus ECU with harnesses	<b>9440131</b>	\$4,949.00
Wireless Scale <b>Libra Cart</b>	<b>9440177</b>	\$3,152.00
Wireless Scale <b>Libra Cart w/ Auto Gate Shutoff*</b>	<b>9440149</b>	\$4,919.00
12 VDC Printer with interface cable	<b>14990</b>	\$1,102.00
Slip plate coating	<b>SLIPPL</b>	Net. \$549.00
Fire Suppression Kit	<b>9440182</b>	\$5,380.00

*\* Libra Cart is Android and Apple compatible*

# SINGLE AUGER GRAIN CARTS

**1300 SA**  
**1500 SA**

## BUSHEL CAPACITY

	1500	1300
Level Full	1500	1300
Heaped	1575	1375

*Bushel capacity measured with #2 corn at 15% moisture content (56 lb. test weight)*



### Standard Feature



**EASY TO FUNCTION IN THE DARK**

### BACK LIT PENDANT GRIP

*Optional ergonomic pendant operates grain flow gate, auger fold, and adjustable spout*

### HYDRAULICS NOTES:

- A standard grain cart requires three hydraulic remotes.
- Optional Pendant Control manages slide gate, folding auger and adjustable spout. Requires one hydraulic remote.
- 70 GPM max oil flow is required for high speed high torque hydraulic unloading drive.

### COLORS AVAILABLE:



*NOTE: Demco grain carts are not to be towed down the road loaded*

### STANDARD FEATURES

- 1 3/4 - 1000 RPM PTO
- **Protect auger driver and tractor PTO** with the automatic reset "cut-out" clutch with overrunning clutch
- Adjustable austempered cast hitch, fits category 4 or 5 hammer strap tractor drawbar
- **High visibility** - reflective decals
- LED Tail, flasher/turn signal lights and auger spotlight for nighttime operation
- **Tube and truss design**
- Welded box construction with silicone sealed seams resists rust and corrosion
- Heavy duty spindles and hubs

### AUGER

- 20" diameter balanced auger with 3/8" flighting and Posi-Drive connection
- UltraFlyte made with 1008/1010 high carbon steel including a thicker outer edge, resulting in up to 50% longer wear and faster conveying
- Forward reach auger for optimum operator visibility
- 2 stage unload auger folding cylinder

### OPTIONS

- Roll top tarp
- Ergonomic pendant control
- Scale kits
- Hydraulic Drive Kit - High Speed / Torque
- Camso Track Systems - 100 Series, 36" Wide Belt
- Soucy Track Systems - 36" Wide Belt





**HOW TO ORDER:** 1. Choose **Model** 2. Choose **Color** 3. Choose **Undercarriage** 4. Review **Accessories**

**MODEL**

*\* All grain carts require a Demco axle*

<b>1300</b> Grain Cart - Gray	<b>9445185</b>	\$64,460.00
<b>1300</b> Grain Cart - Red	<b>9445182</b>	\$64,460.00
<b>1300</b> Grain Cart - Green	<b>9445183</b>	\$64,460.00
<b>1500</b> Grain Cart - Gray	<b>9445189</b>	\$66,028.00
<b>1500</b> Grain Cart - Red	<b>9445186</b>	\$66,028.00
<b>1500</b> Grain Cart - Green	<b>9445187</b>	\$66,028.00

**UNDERCARRIAGE**

<b>1300</b> Axle with 1250 LSW Tires - 10 Bolt		Call for Price and Availability
<b>1300</b> Axle with 1250/50 R32 Tires - 10 Bolt	<b>9445472</b>	\$45,831.00
<b>1300/1500</b> Axle with 1250/50R32 Tires - 20 Bolt	<b>9445473</b>	\$51,645.00
Track System - Camso 100 Series	<b>9445471</b>	\$114,927.00

**FACTORY INSTALLED ACCESSORIES**

<b>1300</b> Roll Up Tarp System	<b>9440162</b>	\$4,590.00
<b>1300</b> Electric Tarp Kit (Does not include tarp)	<b>9440175</b>	\$6,145.00
<b>1500</b> Roll Up Tarp System	<b>9440164</b>	\$4,818.00
<b>1500</b> Electric Tarp Kit (Does not include tarp)	<b>9440173</b>	\$6,145.00
Scale System - 5 Point (Less Console)	<b>9440166</b>	\$7,591.00
12" Auger Spout Extension	<b>9440122</b>	\$315.00
Cat 4 Bull -Pull Hitch™ (I.L.O Cast Hitch)	<b>9440125</b>	\$461.00
Cat 5 Bull -Pull Hitch™ (I.L.O Cast Hitch)	<b>9440127</b>	\$692.00
Pendant Grip Control	<b>9440081</b>	\$3,955.00
High Speed High Torque Hydraulic (70 PGM Max oil flow and 3 remote outlets required)	<b>9445612</b>	\$7,366.00

**FIELD INSTALLED ACCESSORIES**

<b>1300</b> Roll Up Tarp System	<b>9440161</b>	\$3,457.00
<b>1300</b> Electric Tarp Kit (Does not include tarp)	<b>9440174</b>	\$5,638.00
<b>1500</b> Roll Up Tarp System	<b>9440163</b>	\$3,773.00
<b>1500</b> Electric Tarp Kit (Does not include tarp)	<b>9440172</b>	\$5,638.00
Scale System - 5 Point (Less Console)	<b>9440165</b>	\$10,928.00
12" Auger Spout Extension	<b>9440121</b>	\$161.00
Pendant Grip Control	<b>9440104</b>	\$4,482.00
High Speed High Torque Hydraulic Drive (70 GPM Max oil flow and 3 remote outlets required)	<b>9445618</b>	\$7,446.00

**ACCESSORIES**

Slip plate coating (Recommended for Rice)	<b>SLIPPL</b>	Net. \$549.00
Chrome Flighting (In Lieu of Standard Flighting)	<b>9440158</b>	\$3,942.00
Wireless Scale Libra Cart	<b>9440112</b>	\$2,980.00
640 Console with Harness	<b>9440111</b>	\$1,478.00
Pendant Extension Harness	<b>17060</b>	\$660.00

# SINGLE AUGER GRAIN CARTS

**1000 SA**  
**1100 SA**

## BUSHEL CAPACITY

	1000	1100
Level Full	1000	1100
Heaped	1100	1200

*Bushel capacity measured with #2 corn at 15% moisture content (56 lb. test weight)*



### STANDARD FEATURES

- 1 3/4 - 1000 RPM PTO
- Protect auger driver and tractor PTO with the automatic reset "cut-out" clutch with overrunning clutch
- Adjustable austempered cast hitch, fits category 4 or 5 hammer strap tractor drawbar
- High visibility - reflective decals
- LED Tail, flasher/turn signal lights and auger spotlight for nighttime operation
- Tube and truss design - adjustable axle
- Welded box construction with silicone sealed seams resists rust and corrosion
- Heavy duty spindles and hubs

### AUGER

- 20" diameter balanced auger with 3/8" flighting and Posi-Drive connection
- UltraFlyte made with 1008/1010 high carbon steel including a thicker outer edge, resulting in up to 50% longer wear and faster conveying
- Forward reach auger for optimum operator visibility
- 2 stage unload auger folding cylinder

### OPTIONS

- Roll top tarp
- Ergonomic pendant control
- Scale kits
- Hydraulic Drive Kit - High Speed / Torque
  - 1000 SA - 70 Series
  - 1100 SA - 70 or 100 Series
- Soucy Hub Mount Track System

Standard Feature



### BACK LIT PENDANT GRIP

*Optional ergonomic pendant operates grain flow gate, auger fold, and adjustable spout*

### HYDRAULICS NOTES:

- A standard grain cart requires three hydraulic remotes.
- Optional Pendant Control manages slide gate, folding auger and adjustable spout. Requires one hydraulic remote.
- 70 GPM max oil flow is required for high speed high torque hydraulic unloading drive.

COLORS AVAILABLE:



*NOTE: Demco grain carts are not to be towed down the road loaded*





**HOW TO ORDER:** 1. Choose **Model** 2. Choose **Color** 3. Choose **Undercarriage** 4. Review **Accessories**

**MODEL**

*\* All grain carts require a Demco axle*

<b>1000</b> Grain Cart - Gray	<b>9445175</b>	\$47,891.00
<b>1000</b> Grain Cart - Red	<b>9445172</b>	\$47,891.00
<b>1000</b> Grain Cart - Green	<b>9445173</b>	\$47,891.00
<b>1100</b> Grain Cart - Gray	<b>9445179</b>	\$53,159.00
<b>1100</b> Grain Cart - Red	<b>9445176</b>	\$53,159.00
<b>1100</b> Grain Cart - Green	<b>9445177</b>	\$53,159.00

**UNDERCARRIAGE**

Axle with 1250/50 R32 tires	<b>9445477</b>	\$45,228.00
Axle with 1050/50 R32 tires	<b>9445468</b>	\$39,936.00
Axle with 900/60R32 tires	<b>9445467</b>	\$26,562.00
Track System - Camso 70 Series	<b>9445466</b>	\$108,238.00
Track System - Camso 100 Series	<b>9445469</b>	\$114,857.00

**FACTORY INSTALLED ACCESSORIES**

<b>1000/1100</b> Roll Up Tarp System	<b>9440152</b>	\$4,136.00
<b>1000/1100</b> Electric Tarp Kit (Does not include tarp)	<b>9440171</b>	\$5,402.00
Scale System - 5 Point ( <b>Less console</b> )	<b>9440154</b>	\$6,988.00
Scale System - 5 Point Track - 100 Series ONLY ( <b>Less console</b> )	<b>9440160</b>	\$8,820.00
12" Auger Spout Extension	<b>9440122</b>	\$315.00
Cat 3-4 Bull-Pull Hitch™ (I.L.O. Cast Hitch)	<b>9440179</b>	\$1,346.00
Cat 5 Bull-Pull Hitch™ (I.L.O. Cast Hitch)	<b>9440127</b>	\$692.00
Pendant Grip Control	<b>9440081</b>	\$3,955.00
High Speed High Torque Hydraulic (70 GPM Max oil flow and 3 remote outlets required)	<b>9445612</b>	\$7,366.00

**FIELD INSTALLED ACCESSORIES**

<b>1000/1100</b> Roll Up Tarp System	<b>9440151</b>	\$3,526.00
<b>1000/1100</b> Electric Tarp Kit (Does not include tarp)	<b>9440170</b>	\$4,895.00
Scale System - 5 Point ( <b>Less console</b> )	<b>9440153</b>	\$9,529.00
Scale System - 5 Point - 4 Bogie Track ( <b>Less console</b> )	<b>9440159</b>	\$12,469.00
12" Auger Spout Extension	<b>9440121</b>	\$161.00
Pendant Grip Control	<b>9440104</b>	\$4,482.00
High Speed High Torque Hydraulic Drive (70 GPM Max oil flow and 3 remote outlets required)	<b>9445618</b>	\$7,446.00
Cat 3-4 Bull-Pull Hitch	<b>9440180</b>	\$876.00

**ACCESSORIES**

Slip plate coating (Recommended for Rice)	<b>SLIPPL</b>	Net. \$549.00
Chrome Flighting (In Lieu of Standard Flighting)	<b>9440158</b>	\$3,942.00
Wireless Scale Libra Cart	<b>9440112</b>	\$2,980.00
640 Console with Harness	<b>9440111</b>	\$1,478.00
Pendant Extension Harness	<b>17060</b>	\$660.00

# SINGLE AUGER GRAIN CARTS

## 850 SA

### BUSHEL CAPACITY

	850
Level Full	850
Heaped	925

Bushel capacity measured with #2 corn at 15% moisture content (56 lb. test weight)



### Standard Feature



### BACK LIT PENDANT GRIP

Optional ergonomic pendant operates grain flow gate, auger fold, and adjustable spout

### HYDRAULICS NOTES:

- A standard grain cart requires three hydraulic remotes.
- Optional Pendant Control manages slide gate, folding auger and adjustable spout. Requires one hydraulic remote.
- 70 GPM max oil flow is required for high speed high torque hydraulic unloading drive and requires 3 remote outlets.

### COLORS AVAILABLE:



NOTE: Demco grain carts are not to be towed down the road loaded

### STANDARD FEATURES

- 1  $\frac{3}{4}$  - 1000 RPM PTO
- Protect auger driver and tractor PTO with the automatic reset "cut-out" clutch with overrunning clutch
- Adjustable austempered cast hitch, fits category 4 or 5 hammer strap tractor drawbar
- High visibility - reflective decals
- LED Tail, flasher/turn signal lights and auger spotlight for nighttime operation
- Tube and truss design - adjustable axle
- Welded box construction with silicone sealed seams resists rust and corrosion
- Heavy duty spindles and hubs

### AUGER

- 20" diameter balanced auger with 3/8" flighting and Posi-Drive connection
- UltraFlyte made with 1008/1010 high carbon steel including a thicker outer edge, resulting in up to 50% longer wear and faster conveying
- Forward reach auger for optimum operator visibility
- 2 stage unload auger folding cylinder

### OPTIONS

- Roll top tarp
- Ergonomic pendant control
- Scale kits
- Hydraulic Drive Kit - High Speed/Torque
- Camso Track System
  - 850 SA - 70 Series
- Soucy Hub Mount Track System





**HOW TO ORDER:** 1. Choose **Model** 2. Choose **Color** 3. Choose **Undercarriage** 4. Review **Accessories**

**MODEL**

*\*All grain carts require a Demco axle or approved track system*

<b>850</b> Grain Cart - Gray	<b>9445195</b>	\$45,589.00
<b>850</b> Grain Cart - Red	<b>9445191</b>	\$45,589.00
<b>850</b> Grain Cart - Green	<b>9445192</b>	\$45,589.00

**UNDERCARRIAGE**

<b>850</b> Axle with 24.5 x 32 Lug Tires	<b>9445474</b>	\$19,736.00
<b>850</b> Axle with 30.5 x 32 Lug Tires	<b>9445475</b>	\$21,889.00
<b>850</b> Axle with 900/60 R32 Lug Tires	<b>9445476</b>	\$26,163.00
Track System - Camso 70 Series	<b>9445466</b>	\$108,238.00

**FACTORY INSTALLED ACCESSORIES**

<b>850</b> Roll Up Tarp	<b>9440152</b>	\$4,136.00
Scale System - 5 Point (Less Console)	<b>9440154</b>	\$6,988.00
12" Auger Spout Extension	<b>9440122</b>	\$315.00
Cat 3-4 Bull-Pull Hitch™ (I.L.O. Cast Hitch)	<b>9440179</b>	\$1,346.00
Pendant Grip Control	<b>9440081</b>	\$3,955.00
High Speed High Torque Hydraulic (70 PGM Max oil flow and 3 remote outlets required)	<b>9445612</b>	\$7,366.00

**FIELD INSTALLED ACCESSORIES**

<b>850</b> Roll Up Tarp	<b>9440151</b>	\$3,526.00
Scale System - 5 Point (Less Console)	<b>9440153</b>	\$9,529.00
12" Auger Spout Extension	<b>9440121</b>	\$161.00
Pendant Grip Control	<b>9440104</b>	\$4,482.00
High Speed High Torque Hydraulic Drive (70 PGM Max oil flow and 3 remote outlets required)	<b>9445618</b>	\$7,446.00
Cat 3-4 Bull-Pull Hitch	<b>9440180</b>	\$876.00

**ACCESSORIES**

Slip plate coating	<b>SLIPPL</b>	Net. \$549.00
Chrome Flighting (In Lieu of Standard Flighting)	<b>9440158</b>	\$3,942.00
Wireless Scale Libra Cart	<b>9440112</b>	\$2,980.00
640 Console with Harness	<b>9440111</b>	\$1,478.00

*\* Libra Cart is Android and Apple compatible*

# SINGLE AUGER GRAIN CARTS

**650**  
**750**



## BUSHEL CAPACITY

	650	750
Level Full	625	700
Heaped	675	725

*Bushel capacity measured with #2 corn at 15% moisture content (56 lb. test weight)*

## STANDARD FEATURES

- 1000 RPM PTO
- **Protect auger driver and tractor PTO** with the automatic reset "cut-out" clutch with overrunning clutch
- 2 grain viewing windows
- 7,000 lb. drop-leg tongue jack with separate storage position **provides tighter turning radius**
- Hand wheel operated clean-out door at bottom of auger for **easy post season clean-out**
- 30" hydraulic controlled flow gate
- **High visibility** - reflective decals
- LED Tail, flasher/turn signal lights and auger spotlight for nighttime operation
- **Transport width: 12' 9"**
- Welded box construction with silicone sealed seams resists rust and corrosion
- 22,500 lb. Ductile Iron Hubs

Optional Feature



**EASY TO FUNCTION IN THE DARK**

### BACK LIT PENDANT GRIP

*Optional ergonomic pendant operates grain flow gate, auger fold, and adjustable spout*

## AUGER

- 14" diameter balanced auger with 3/8" flighting and Posi-Drive connection
- UltraFlyte made with 1008/1010 high carbon steel including a thicker outer edge, resulting in up to 50% longer wear and faster conveying
- Forward reach auger for optimum operator visibility
- Auger folds within the width of the box for compact transporting and storage

## OPTIONS

- Hydraulic Drive Kit (15-25 GPM oil flow required)
- Roll top tarp
- Ergonomic pendant control
- Adjustable auger spout
- Scale Kits

## HYDRAULICS NOTES:

- A standard grain cart requires two hydraulic remotes.

COLORS AVAILABLE:



*NOTE: Demco grain carts are not to be towed down the road loaded*



**HOW TO ORDER:** 1. Choose **Model** 2. Choose **Color** 3. Choose **Axle Type** 4. Choose **Drive Package** 5. Choose **Wheels** 6. Review **Accessories**

**MODEL**

*\* All grain carts require a Demco axle*

<b>650</b> Grain Cart - Gray	<b>9445136</b>	\$26,870.00
<b>650</b> Grain Cart - Red	<b>9445041</b>	\$26,870.00
<b>650</b> Grain Cart - Green	<b>9445042</b>	\$26,870.00
<b>750</b> Grain Cart - Gray	<b>9445137</b>	\$31,555.00
<b>750</b> Grain Cart - Red	<b>9445043</b>	\$31,555.00
<b>750</b> Grain Cart - Green	<b>9445044</b>	\$31,555.00

**AXLE TYPE**

<b>650</b> - 120" Axle less wheels	<b>9445405</b>	\$7,465.00
<b>650</b> - 120" - 144" Adj. Axle less wheels (for use with single wheels)	<b>9445406</b>	\$8,379.00
<b>650/750</b> - Dual Wheels fixed 120" - 180" less wheels	<b>9445419</b>	\$10,112.00
<b>750</b> - 120" Axle less wheels	<b>9445409</b>	\$9,146.00
<b>750</b> - 120" - 144" Adj. Axle less wheels (for use with single wheels)	<b>9445410</b>	\$10,530.00

**DRIVE PACKAGE**

1000 RPM PTO - 1 3/8" spline with automatic clutch	<b>13399</b>	\$1,089.00
1000 RPM PTO - 1 3/4" spline with automatic clutch	<b>13398</b>	\$1,190.00
Hydraulic drive (15-25 GPM oil flow required. Reduces auger speed)	<b>9445611</b>	\$2,773.00

**WHEELS AND TIRES (2 REQUIRED)**

24.5 x 32 12 ply lug tire & wheel (silver) (09380-60)	<b>9445201-60</b>	\$5,094.00/ea x 2=	\$10,188.00
24.5 x 32 12 ply diamond tire & wheel (silver) (09380-60) <i>Special Order</i>	<b>9445202-60</b>	\$6,035.00/ea x 2=	\$12,070.00
30.5 x 32 12 ply lug tire & wheel (silver) (09381-60)	<b>9445203-60</b>	\$6,131.00/ea x 2=	\$12,262.00
30.5 x 32 12 ply diamond tire & wheel (silver) (09381-60) <i>Special Order</i>	<b>9445204-60</b>	\$6,502.00/ea x 2=	\$13,004.00
Duals - 18.4 x 38 - 8 ply lug tire & wheel (silver) 30" row spacing	<b>9445215-60</b>	\$12,483.00/ea x 2=	\$24,966.00
Duals - 520/85R38 155B load index, lug tire & wheel (silver)(10830-60)30" row spacing	<b>9445213-60</b>	\$12,167.00/ea x 2=	\$24,334.00

*Note: Units ordered less wheels is NOT recommended and voids any and all warranty consideration on hubs, spindles, bearings, axle and related components*

**FACTORY INSTALLED ACCESSORIES**

Roll Up Tarp* (end caps reduce load capacity)	<b>9440090</b>	\$3,300.00
Scale ( <b>less console</b> )	<b>9440067</b>	\$4,473.00
Pendant Grip Control	<b>9440082</b>	\$2,695.00

**FIELD INSTALLED ACCESSORIES**

Roll Up Tarp (end caps reduce load capacity)	<b>9440020</b>	\$2,661.00
Scale ( <b>less console</b> )	<b>9440069</b>	\$5,172.00
Standard Hydraulic Drive (15-25 GPM oil flow required. Reduces auger speed)	<b>9445611</b>	\$2,773.00
Pendant Grip Control	<b>9440105</b>	\$3,241.00

**ACCESSORIES**

640 Console with harnesses	<b>9440111</b>	\$1,478.00
Wireless Scale <b>Libra Cart*</b>	<b>9440112</b>	\$2,980.00
15' Harness Extension for Scale	<b>13266</b>	\$298.00
12 VDC Printer with interface cable	<b>14990</b>	\$1,102.00
Adjustable Auger Spout (requires 1 hydraulic remote)	<b>9440077</b>	\$1,370.00
Slip Plate Coating	<b>SLIPPL</b>	Net. \$549.00

*\* Roll tarps: some dealer assembly required. Tarp & bows are removed due to shipping restrictions*

*\* Libra Cart is Android and Apple compatible*

# GRAIN WAGONS STRONGER & SAFER

**500 SS**  
**650 SS**  
**750 SS**



*Demco wagons lead the industry in unloading performance!*

## BUSHEL CAPACITY

500 SS - 500 bushels

650 SS - 650 bushels

750 SS - 750 bushels

Bushel capacity measured with #2 corn at 15% moisture content (56 lb. test weight)

**NOTE: All capacities are based on level full**

*NOTE: Used truck tires furnished by Demco will vary in quality and outward appearance. Demco will guarantee used tires to hold air for 30 days from date wagon is delivered to dealer lot and assumes no warranty or liability on used tires once removed from dealer premises.*

*NOTE: Units are factory setup.*

**COLORS AVAILABLE:**



## STANDARD FEATURES

- Easiest opening door in the industry
- Adjustable door opener for easy access from either side of chute
- Ergonomic tongue latch
- Reflective decals
- LED lights
- 22" hand wheel
- Large viewing windows: 12" x 24"
- More chute clearance
- Fenders - 650/750
- Cast spindle carriers
- 3-1/2" bolt in spindles
- 10 bolt hubs
- Narrow box width for better visibility
- New interior bracing for less grain splatte
- 2 wheel (rear) brakes - 500 SS
- 4 wheel brakes - 650 SS/750 SS

## OPTIONS

- Additional Front brakes - 500 SS
- Fenders - 500 SS
- Roll tarp
- Rear ladder kit
- Electric door opener





Adjustable Door Opener  
with Larger Hand Wheel



Cast Spindle Carriers -  
front and rear

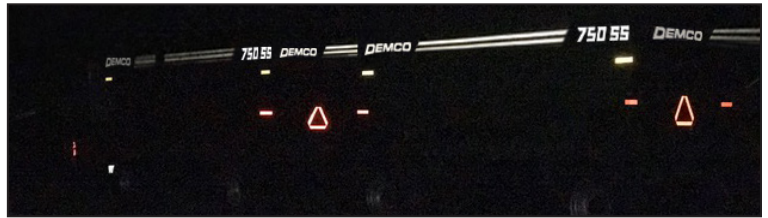

**REFLECTIVE DECALS**

The photo above shows the superior safety of our new, reflective decals at night!



**500 SS & 650 SS**

Heavy duty torsion bar suspension reduces wagon stress and improves ride and handling



**750 SS**

**HOW TO ORDER:** 1. Choose **Wagon** 2. Review **Accessories**

**WAGON**

**w/425-65R 22.5 Used Tires**

<b>500 SS</b> Wagon - Gray	<b>9443190</b>	\$30,197.00
<b>500 SS</b> Wagon - Red	<b>9443161</b>	\$30,197.00
<b>500 SS</b> Wagon - Green	<b>9443162</b>	\$30,197.00
<b>650 SS</b> Wagon - Gray	<b>9443191</b>	\$35,997.00
<b>650 SS</b> Wagon - Red	<b>9443167</b>	\$35,997.00
<b>650 SS</b> Wagon - Green	<b>9443168</b>	\$35,997.00

**w/445-65R 22.5 Used Tires**

<b>500 SS</b> Wagon - Gray	<b>9443192</b>	\$30,912.00
<b>500 SS</b> Wagon - Red	<b>9443164</b>	\$30,912.00
<b>500 SS</b> Wagon - Green	<b>9443165</b>	\$30,912.00
<b>650 SS</b> Wagon - Gray	<b>9443193</b>	\$36,664.00
<b>650 SS</b> Wagon - Red	<b>9443170</b>	\$36,664.00
<b>650 SS</b> Wagon - Green	<b>9443171</b>	\$36,664.00
<b>750 SS</b> Wagon - Gray	<b>9443194</b>	\$39,487.00
<b>750 SS</b> Wagon - Red	<b>9443176</b>	\$39,487.00
<b>750 SS</b> Wagon - Green	<b>9443177</b>	\$39,487.00

**w/455-55R 22.5 Used Tires**

<b>750 SS</b> Wagon - Gray	<b>9443196</b>	\$40,826.00
<b>750 SS</b> Wagon - Red	<b>9443179</b>	\$40,826.00
<b>750 SS</b> Wagon - Green	<b>9443180</b>	\$40,826.00

**\* New tires are special order - call for pricing**

**FACTORY INSTALL ACCESSORIES**

<b>500 SS</b> Additional Front Brakes	<b>9440178</b>	\$731.00
<b>500 SS</b> Fenders	<b>9440134</b>	\$1,411.00
<b>500 SS</b> Roll tarp	<b>9440136</b>	\$2,580.00
<b>500 SS</b> Rear Ladder Kit	<b>6282</b>	\$455.00
<b>650 SS &amp; 750 SS</b> Rear Ladder Kit	<b>6293</b>	\$455.00
<b>650 SS &amp; 750 SS</b> Roll tarp	<b>9440138</b>	\$2,667.00
Electric Door Opener	<b>9440147</b>	\$1,985.00

**FIELD INSTALL ACCESSORIES**

<b>500 SS</b> Fenders	<b>9440135</b>	\$1,270.00
<b>500 SS</b> Roll tarp	<b>9440137</b>	\$2,200.00
<b>650 SS &amp; 750 SS</b> Roll tarp	<b>9440139</b>	\$2,286.00
Electric Door Opener	<b>9440148</b>	\$1,637.00

# ALL WHEEL STEER HEADER TRANSPORTS

32' • 38' • 42' • 48' • 52'

**NEW**

## High Speed AWS Header Transport

- ◀ DEMCO's newest Header Transport gives you the **All Wheel Steer maneuverability along with the HIGH SPEED** features of the Standard & Heavy Duty transports.
- ◀ All Header Transport features designed into 1 Header Transport
- ◀ As the Combine Headers get larger, Demco's HIGH SPEED All Wheel Steer design will check all the boxes that you are looking for in a Header Transport.
- ◀ Available in 32' - 38' - 42' - 48' - 52' lengths



### STANDARD FEATURES

- 7K Torsion Flex Front & Rear Axles
- Tandem Rear Torsion Steerable Axles with 1 Brake (32' - 38' - 42')
- Tandem Rear Torsion Steerable Axles with 2 Brakes (48' - 52')
- 91" Telescoping Tongue w/ Clevis & 1" Hitch Pin
- LED Lighting w/ 7 pole RV plug
- 8 Bolt Hubs w/ ST 235/80R16 Tires
- 2 Adjustable Tie Downs
- 2 Adjustable Mounting Brackets (32' - 38')
- 4 Adjustable Mounting Brackets (42' - 48' - 52')
- GVW = 21,000 lbs
- Poly Front Fenders

### OPTIONS

- 139" Telescoping Tongue
- 1 5/16 EZ Latch Coupler or 3" Pintle Ring
- Electric Brakes - Front Axle and 2nd Rear Axle
- Mounting brackets to fit all models of headers







## DRAPER BRACKETS



Standard Draper Bracket



L5 Draper Bracket



Hinged Draper Bracket

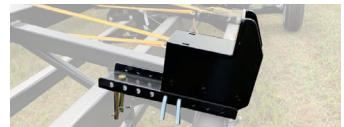

L8 Draper Bracket

**HOW TO ORDER:** 1. Choose **Header Transports** 2. Review **Options**

### HEADER TRANSPORT

32' Header Transport	<b>2H000391</b>	\$18,952.00
38' Header Transport	<b>2H000392</b>	\$20,355.00
42' Header Transport	<b>2H000393</b>	\$22,341.00
48' Header Transport	<b>2H000394</b>	\$23,910.00
52' Header Transport	<b>2H000371</b>	\$24,741.00

### UPGRADE OPTIONS - pricing in lieu of Standard Features

91" Telescoping Tongue w/ Ball Coupler (I.L.O. Clevis)	<b>2H000373</b>	\$139.00
91" Telescoping Tongue w/ Pintle Eye (I.L.O. Clevis)	<b>2H000374</b>	\$100.00
AWS 7K Front Axle-Brake, (48 - 52)	<b>2H000376</b>	\$913.00
AWS 7K Rear Axle - 2 Brake (32' - 38' - 42')	<b>2H000396</b>	\$658.00
AWS 7K Front Axle - Brake (32' - 38' - 42')	<b>2H000400</b>	\$913.00
139" Telescoping Tongue - Clevis	<b>2H000385</b>	\$624.00
139" Telescoping Tongue - Pintle	<b>2H000386</b>	\$543.00

### ADDITIONAL OPTIONS

Additional Adjustable Tie Downs (Each)	<b>5H000148</b>	\$148.00
Standard Saddle Bracket Assembly - Right	<b>9H000005</b>	\$425.00
Standard Saddle Bracket Assembly - Left	<b>9H000005</b>	\$425.00
L5 Bracket Assembly	<b>9H000035</b>	\$464.00
L8 Bracket Assembly	<b>9H000067</b>	\$504.00
MacDon 200 Series Brackets - 32'	<b>9H000101</b>	\$990.00
MacDon 200 Series Brackets - 38'	<b>9H000102</b>	\$990.00
MacDon 200 Series Brackets - 42' - 48' - 52'	<b>9H000100</b>	\$990.00
JohnDeere Hinged Draper Brackets	<b>9H000094</b>	\$445.00
AWS Rear Fender	<b>2H000379</b>	\$651.00

# STANDARD HEADER TRANSPORTS

20' • 24' • 28'

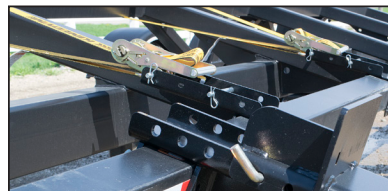

*Two fully adjustable ratcheting straps for securing all brands of heads*

## STANDARD FEATURES

- 6K Torsion Flex Tricycle Front & Rear Axles
- Single Rear Torsion Flex Axle
- Axle Down Configuration (Axle Up Configuration available)
- LED Lighting w/ 7 pole RV plug
- New 225/75R15 Load Range E Import Tires
- Black Paint with Rubberized Undercoating
- 2 Adjustable Tie Downs
- 46" Telescoping Tongue w/ Clevis & 1" Hitch Pin
- 2 Standard Saddle Brackets
- GVW 11,200 lbs.

## OPTIONS

- 71" Telescoping Tongue
- 2-5/16 Ball Coupler or 3" Pintle Ring
- Electric Brakes - Front and Rear
- Brackets: Standard/L5/Hinged Draper/L8
- MacDon 200 Series Brackets
- Top Rail Extender
- Fenders - Front and Rear

## DRAPER BRACKETS



Standard Draper Bracket



L5 Draper Bracket



Hinged Draper Bracket

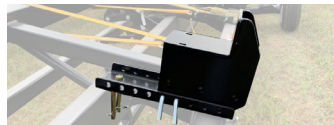

L8 Draper Bracket

**HOW TO ORDER:** 1. Choose **Header Transporter** 2. Review **Options**

### HEADER TRANSPORT

20' Header Transport	<b>2H000304</b>	\$9,526.00
24' Header Transport	<b>2H000305</b>	\$10,121.00
28' Header Transport	<b>2H000306</b>	\$11,051.00

### UPGRADE OPTIONS - pricing in lieu of Standard Features

46" Telescoping Tongue w/ 2 5/16" Ball Coupler (I.L.O. Clevis)	<b>2H000136</b>	\$137.00
46" Telescoping Tongue w/ 3" Pintle Eye (I.L.O. Clevis)	<b>2H000141</b>	\$98.00
71" Telescoping Tongue w/ Clevis Hitch (I.L.O. Standard Tongue)	<b>2H000132</b>	\$197.00
71" Telescoping Tongue w/ 2 5/16" Ball Coupler (I.L.O. Standard Tongue)	<b>2H000133</b>	\$295.00
71" Telescoping Tongue w/ 3" Pintle Eye (I.L.O. Standard Tongue)	<b>2H000135</b>	\$249.00
Electric Brakes w/ Breakaway on Single Rear Axle	<b>2H000331</b>	\$644.00
Front Braking Torsion Flex Tricycle Axle (I.L.O. Standard Idler Axle)	<b>2H000169</b>	\$716.00

### ADDITIONAL OPTIONS

Front Fender Package	<b>5H000415</b>	\$390.00
Rear Fender Package - Single Axle	<b>5H000190</b>	\$336.00
Spare Tire Mounted w/ Carrier	<b>2H000113</b>	\$429.00
Additional Adjustable Tie Downs (Each)	<b>5H000148</b>	\$148.00
Manufacture Statement of Origin	<b>MSO</b>	Net. \$30.00
Standard Saddle Bracket Assembly - Right	<b>9H000005</b>	\$425.00
Standard Saddle Bracket Assembly - Left	<b>9H000006</b>	\$425.00
L5 Bracket Assembly	<b>9H000035</b>	\$464.00
L8 Bracket Assembly	<b>9H000067</b>	\$504.00
JohnDeere Hinged Draper Brackets	<b>9H000094</b>	\$445.00
Top Rail Extender Kit - 20' - <b>9H000056</b> / 24' - <b>9H000057</b> / 28' - <b>9H000058</b>		\$1,239.00



# STANDARD HEADER TRANSPORTS

32' • 38' • 42'

## STANDARD FEATURES

- 6K Torsion Flex Tricycle Front & Rear Axles
- Single Rear Torsion Flex Axle (32', 38')
- Tandem Rear Torsion Flex Axle (42')
- Axle Down Configuration
- 1 Rear Brake Standard on 42'
- LED Lighting w/ 7 pole RV plug
- New 225/75R15 Load Range E Import Tires
- Black Paint with Rubberized Undercoating
- 2 Adjustable Tie Downs
- 46" Telescoping Tongue w/ Clevis & 1" Hitch Pin
- 2 Adjustable Slider Brackets (32', 38')
- 4 Adjustable Slider Brackets (42')
- Single Rear Axle GVW 11,200 lbs.
- Tandem Rear Axle GVW 16,800 lbs.
- Poly Front Fenders

## OPTIONS

- 71" Telescoping Tongue
- 2-5/16 Ball Coupler or 3" Pintle Ring
- Electric Brakes - Front and Rear
- Rear Fenders
- Tandem Rear Torsion Axles(32' - 38')
- Brackets: Standard/L5/Hinged Draper/L8
- MacDon 200 Series Brackets
- Top Rail Extender



*Torsion flex axles provide a smooth ride*

**HOW TO ORDER:** 1. Choose **Header Transporter** 2. Review **Options**

### HEADER TRANSPORT

32' Header Transport	<b>2H000307</b>	\$12,369.00
38' Header Transport	<b>2H000308</b>	\$13,821.00
42' Header Transport	<b>2H000309</b>	\$19,474.00

### UPGRADE OPTIONS - pricing in lieu of Standard Features

46" Telescoping Tongue w/ 2 5/16" Ball Coupler (I.L.O. Clevis)	<b>2H000136</b>	\$137.00
46" Telescoping Tongue w/ 3" Pintle Eye (I.L.O. Clevis)	<b>2H000141</b>	\$98.00
71" Telescoping Tongue w/ Clevis Hitch (I.L.O. Standard Tongue)	<b>2H000132</b>	\$197.00
71" Telescoping Tongue w/ 2 5/16" Ball Coupler (I.L.O. Standard Tongue)	<b>2H000133</b>	\$295.00
71" Telescoping Tongue w/ 3" Pintle Eye (I.L.O. Standard Tongue)	<b>2H000135</b>	\$249.00
Electric Brakes w/Breakaway on Single Rear Axle	<b>2H000162</b>	\$644.00
Rear Tandem Suspension w/o Brakes (2 Idler Axles)	<b>2H000165</b>	\$2,127.00
Rear Tandem Suspension w/ Brakes (1 Idler, 1 Electric Brake Axles)	<b>2H000166</b>	\$2,771.00
Rear Tandem Suspension w/ Brakes (2 Electric Brake Axles)	<b>2H000164</b>	\$3,256.00
Front Braking Torsion Flex Tricycle Axle (I.L.O. Standard Idler Axle)	<b>2H000170</b>	\$716.00
<b>42'</b> Electric Brakes on Second Rear Axle	<b>2H000167</b>	\$485.00

### ADDITIONAL OPTIONS

Rear Fender Package - Single Axle	<b>5H000190</b>		\$336.00
Rear Fender Package - Tandem Axle	<b>5H000190</b>	\$336.00/ea x 2=	\$672.00
Spare Tire Mounted w/Carrier	<b>2H000113</b>		\$429.00
Additional Adjustable Tie Downs (Each)	<b>5H000148</b>		\$148.00
Manufacture Statement of Origin (MSO)	<b>MSO</b>		Net. \$30.00
Standard Saddle Bracket Assembly - Right	<b>9H000005</b>		\$425.00
Standard Saddle Bracket Assembly - Left	<b>9H000006</b>		\$425.00
L5 Bracket Assembly	<b>9H000035</b>		\$464.00
L8 Bracket Assembly	<b>9H000067</b>		\$504.00
JohnDeere Hinged Draper Brackets	<b>9H000094</b>		\$445.00
MacDon 200 Series Brackets - 32'	<b>9H000101</b>		\$990.00
MacDon 200 Series Brackets - 38'	<b>9H000102</b>		\$990.00
MacDon 200 Series Brackets - 42'	<b>9H000100</b>		\$990.00
Top Rail Extender Kit - 32' - <b>9H000059</b> / 38' - <b>9H000061</b>			\$1,859.00
Top Rail Extender Kit - 42'	<b>9H000062</b>		\$2,469.00

# STANDARD HEADER TRANSPORTS

48' • 52'



*Torsion flex axles provide a smooth ride*

## STANDARD FEATURES

- 7K Torsion Flex Tricycle Front & Rear Axles
- Tandem Rear Torsion Flex Axle with 2 Brakes
- Axle Down Configuration
- LED Lighting w/ 7 pole RV plug
- New 16" ST 235/80R16 Load Range E Tires
- 8 Bolt Hubs
- Black Paint with Rubberized Undercoating
- 2 Adjustable Tie Downs
- 46" Telescoping Tongue w/ Clevis & 1" Hitch Pin
- 4 Adjustable Slider Brackets
- Tandem Rear Axle GVW 20,000 lbs.
- Poly Front Fenders

## OPTIONS

- 71" Telescoping Tongue
- 2-5/16 Ball Coupler or 3" Pintle Ring
- Electric Brakes - Front Axle
- Rear Fenders
- Brackets: Standard/L5/Hinged Draper/L8
- MacDon 200 Series Brackets
- Top Rail Extender

**HOW TO ORDER:** 1. Choose **Header Transporter** 2. Review **Options**

### HEADER TRANSPORT

48' Header Transport	<b>2H000323</b>	\$21,824.00
52' Header Transport	<b>2H000327</b>	\$24,095.00

### UPGRADE OPTIONS - pricing in lieu of Standard Features

46" Telescoping Tongue w/ 2 5/16" Ball Coupler (I.L.O. Clevis)	<b>2H000136</b>	\$137.00
46" Telescoping Tongue w/ 3" Pintle Eye (I.L.O. Clevis)	<b>2H000141</b>	\$98.00
71" Telescoping Tongue w/ Clevis Hitch (I.L.O. Standard Tongue)	<b>2H000132</b>	\$197.00
71" Telescoping Tongue w/ 2 5/16" Ball Coupler (I.L.O. Standard Tongue)	<b>2H000133</b>	\$295.00
71" Telescoping Tongue w/ 3" Pintle Eye (I.L.O. Standard Tongue)	<b>2H000135</b>	\$249.00
Front Braking Torsion Flex Tricycle Axle (I.L.O. Standard Idler Axle)	<b>2H000170</b>	\$716.00

### ADDITIONAL OPTIONS

Rear Fender Package - Tandem Axle	<b>5H000200</b>	\$332.00/ea x 2=	\$664.00
Spare Tire Mounted w/Carrier	<b>2H000212</b>		\$484.00
Additional Adjustable Tie Downs (Each)	<b>5H000148</b>		\$148.00
Manufacture Statement of Origin (MSO)	<b>MSO</b>		Net \$30.00
Standard Saddle Bracket Assembly - Right	<b>9H000005</b>		\$425.00
Standard Saddle Bracket Assembly - Left	<b>9H000006</b>		\$425.00
L5 Bracket Assembly	<b>9H000035</b>		\$464.00
L8 Bracket Assembly	<b>9H000067</b>		\$504.00
MacDon 200 Series Brackets	<b>9H000100</b>		\$990.00
JohnDeere Hinged Draper Brackets	<b>9H000094</b>		\$445.00
Shelbourne Brackets, Qty 2 (Requires Draper Brackets)	<b>9H000070</b>		\$825.00
Top Rail Extender Kit - 48'	<b>9H000063</b>		\$2,499.00
Top Rail Extender Kit - 52'	<b>9H000091</b>		\$2,622.00



# HEAVY DUTY HEADER TRANSPORTS

32' • 38' • 42'



## STANDARD FEATURES

- 7K Torsion Flex Tricycle Front & Rear Axles
- Axle Down Configuration
- 1 Rear Brake
- LED Lighting w/ 7 pole RV plug
- New 16" ST 235/80R16 Load Range E Tires on 8 Bolt Hub
- Black Paint with Rubberized Undercoating
- Manufacturer's Statement of Origin (MSO)
- Front and Rear Fenders
- Horizontal Rear Bumper
- 2 Adjustable Tie Downs
- 46" Telescoping Tongue w/ 2-5/16" Ball Hitch
- 2 Adjustable Slider Brackets(32, 38)
- 4 Adjustable Slider Brackets (42)
- GVW 20,000 lbs.
- Additional Options Available

## OPTIONS

- 71" Telescoping Tongue
- 3" Pintle Ring
- Electric Brakes - Front and Rear
- Brackets: Standard/L5/Hinged Draper/L8
- MacDon 200 Series Brackets
- Cotton Header Brackets
- Top Rail Extender

*Standard telescoping tongue and eZ-Latch 2 5/16" ball coupler and safety chains*



*Optional top rail extender kit*



*Cotton Head brackets and extender kits available. Contact your Demco Rep for part numbers and pricing.*

**HOW TO ORDER:** 1. Choose **Header Transporter** 2. Review **Options**

### HEADER TRANSPORT

32' Heavy Duty Header Transport	<b>2H000310</b>	\$18,939.00
38' Heavy Duty Header Transport	<b>2H000311</b>	\$20,718.00
42' Heavy Duty Header Transport	<b>2H000312</b>	\$23,894.00

### UPGRADE OPTIONS - pricing in lieu of Standard Features

46" Telescoping Tongue w/ 3" Pintle Eye (I.L.O. Ball)	<b>2H000141</b>	\$98.00
71" Telescoping Tongue w/ 2 5/16" Ball Coupler (I.L.O. Standard Tongue)	<b>2H000133</b>	\$295.00
71" Telescoping Tongue w/ 3" Pintle Eye (I.L.O. Standard Tongue)	<b>2H000135</b>	\$249.00
Electric Brakes on Second Rear Axle	<b>2H000207</b>	\$485.00
Front Braking Torsion Flex Tricycle Axle (I.L.O. Standard Idler Axle)	<b>2H000234</b>	\$913.00

### ADDITIONAL OPTIONS

Spare Tire Mounted w/ Carrier -HD Model	<b>2H000212</b>	\$484.00
Additional Adjustable Tie Downs (Each)	<b>5H000148</b>	\$148.00
Standard Saddle Bracket Assembly - Right	<b>9H000005</b>	\$425.00
Standard Saddle Bracket Assembly - Left	<b>9H000006</b>	\$425.00
L5 Bracket Assembly	<b>9H000035</b>	\$464.00
L8 Bracket Assembly	<b>9H000067</b>	\$504.00
MacDon 200 Series Brackets	<b>9H000100</b>	\$990.00
JohnDeere Hinged Draper Brackets	<b>9H000094</b>	\$445.00
Top Rail Extender Kit (HT32 & HT38) - 32' - <b>9H000059</b> / 38' - <b>9H000061</b>		\$1,859.00
Top Rail Extender Kit (HT42) - 42' -	<b>9H000062</b>	\$2,469.00
Shelbourne Brackets Qty 2 (Available for 32', 38' & 42' - Requires Draper Brackets)	<b>9H000070</b>	\$825.00

# HEAVY DUTY HEADER TRANSPORTS

48' • 52'



## STANDARD FEATURES

- 7K Torsion Flex Tricycle Front & Rear Axles
- Axle Down Configuration
- 2 Rear Brakes Standard
- LED Lighting w/ 7 pole RV plug
- New 16" ST 235/80R16 Load Range E Tires on 8 Bolt Hub
- Black Paint with Rubberized Undercoating
- Manufacturer's Statement of Origin (MSO)
- Front and Rear Fenders
- Horizontal Rear Bumper
- 2 Adjustable Tie Downs
- 46" Telescoping Tongue w/ 2-5/16" Ball Hitch
- 4 Adjustable Slider Brackets
- GVW 20,000 lbs.
- Additional Options Available

## OPTIONS

- 71" Telescoping Tongue
- 3" Pintle Ring
- Electric Brakes - Front and Rear
- Brackets: Standard/L5/Hinged Draper/L8
- MacDon 200 Series Brackets
- Cotton Header Brackets
- Top Rail Extender

*Standard telescoping tongue and eZ-Latch 2 5/16" ball coupler and safety chains*



*Optional top rail extender kit*

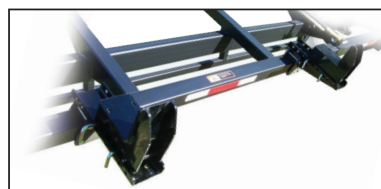

**HOW TO ORDER:** 1. Choose **Header Transporter** 2. Review **Options**

### HEADER TRANSPORT

48' Heavy Duty Header Transport	<b>2H000313</b>	\$27,309.00
52' Heavy Duty Header Transport	<b>2H000328</b>	\$30,120.00

### UPGRADE OPTIONS - pricing in lieu of Standard Features

46" Telescoping Tongue w/ 3" Pintle Eye (I.L.O. Ball)	<b>2H000141</b>	\$98.00
71" Telescoping Tongue w/ 2 5/16" Ball Coupler (I.L.O. Standard Tongue)	<b>2H000133</b>	\$295.00
71" Telescoping Tongue w/ 3" Pintle Eye (I.L.O. Standard Tongue)	<b>2H000135</b>	\$249.00
Front Braking Torsion Flex Tricycle Axle (I.L.O. Standard Idler Axle)	<b>2H000347</b>	\$913.00

### ADDITIONAL OPTIONS

Spare Tire Mounted w/ Carrier -HD Model	<b>2H000212</b>	\$484.00
Additional Adjustable Tie Downs (Each)	<b>5H000148</b>	\$148.00
Standard Saddle Bracket Assembly - Right	<b>9H000005</b>	\$425.00
Standard Saddle Bracket Assembly - Left	<b>9H000006</b>	\$425.00
L5 Bracket Assembly	<b>9H000035</b>	\$464.00
L8 Bracket Assembly	<b>9H000067</b>	\$504.00
MacDon 200 Series Brackets	<b>9H000100</b>	\$990.00
JohnDeere Hinged Draper Brackets	<b>9H000094</b>	\$445.00
Top Rail Extender Kit (HT48)	<b>9H000063</b>	\$2,499.00
Top Rail Extender Kit (HT52)	<b>9H000091</b>	\$2,622.00
Shelbourne Brackets Qty 2 (Available for 32', 38' & 42' - Requires Draper Brackets)	<b>9H000070</b>	\$825.00



**Don't settle for less - Demco Tip-ups will help add capacity to your existing OEM extension.**

## STANDARD FEATURES

- Easy installation
- Durable and sturdy design
- Convenient fold down for storage and transport
- Unmatched quality
- Attractive appearance
- Additional 60 bushels: 8" tall
- Additional 120 bushels: 14" tall



## JOHN DEERE

**HOW TO ORDER:** 1. Choose **Correct Part Number** 2. Determine **Extension Size** 3. Review **Accessories**

COMBINE MODEL	ADDED BUSHELS:	YEAR	MODEL	PART NO.	PRICE
9660/9670/9760/9770/9860/9870 STS	300 + 60 bu.		M60	<b>9E000018</b>	\$1,939.00
9660/9670/9760/9770/9860/9870 STS	300 + 120 bu.		M120	<b>9E000021</b>	\$2,821.00
S660/S670	300 + 60 bu.	2012-2014*	MS67	<b>9E000041</b>	\$2,021.00
S660/S670	300 + 120 bu.	2012-2014*	MS120	<b>9E000036</b>	\$2,913.00
S660/S670/S760/S770	300 + 60 bu.	2014*-2023	MS67SQ	<b>9E000047</b>	\$2,217.00
S660/S670/S760/S770	300 + 120 bu.	2014*-2023	MS120 SQ	<b>9E000046</b>	\$3,099.00
S680/S690	400 + 60 bu.	2012-2014*	MS60	<b>9E000037</b>	\$1,939.00
S680/S690/S780/S790	400 + 60 bu.	2014*-2023	MS60SQ	<b>9E000043</b>	\$1,939.00

*\* Contact a Demco Representative when ordering a Tip-Up kit for a 2014 JD S Series Combine*



## CASE-IH AND NEW HOLLAND

**HOW TO ORDER:** 1. Choose **Correct Part Number** 2. Determine **Extension Size** 3. Review **Accessories**

CASE IH COMBINE MODEL	ADDED BUSHELS:	HEIGHT	MODEL	PART NO.	PRICE
5088/5130 /5140/5150/6150/7150	24" + 100 bu.	14" Tall	MX250	<b>9E000025</b>	\$2,821.00
5088/5130/6088/6130/7088/7130/ 5140/6140/7140/ 5150/6150/7150	32" + 100 bu.	14" Tall	MX300	<b>9E000024</b>	\$2,821.00
7010/7120/7230/7240	24" + 100 bu.	14" Tall	MZ315	<b>9E000026</b>	\$2,821.00
7230/8010/8120/8230/9120/9230	27" + 100 bu.	14" Tall	MZ350	<b>9E000027</b>	\$2,821.00
7240/ 8240/9240/7250/8250/9250	33" + 65 bu.	8" Tall	MX410	<b>9E000048</b>	\$2,821.00
<b>NEW HOLLAND COMBINE MODEL</b>					
CR940/CR960/CR9040/CR9060/CR6090/ CR7090/CR8080/ CR6.80, CR6.90, CR7.90	24" + 100 bu.	14" Tall	MZ315	<b>9E000026</b>	\$2,821.00
CR970/CR980/ CR9070/CR9080/CR9090	27" + 100 bu.	14" Tall	MZ350	<b>9E000027</b>	\$2,821.00
CR8090/CR9090/CR8.90/CR9.90	33" + 65 bu.	8" Tall	MZ410	<b>9E000045</b>	\$2,821.00

*NOTE: All capacities are based on level full*

# DEMCO TIP UP KITS - POWER FOLD

Demco Tip-Ups for power fold combines allow you to gain more capacity while using the OEM power fold extension.



**HOW TO ORDER:** 1. Choose **Correct Part Number** 2. Determine **Extension Size** 3. Review **Accessories**

COMBINE MODEL	ADDED BUSHELS:	YEAR	HEIGHT	MODEL	PART NO.	PRICE
<b>JOHN DEERE FACTORY POWER FOLD EXTENSION</b>						
S660/S670/S760/S770	300 + 150 bu.		14" Tall	MS150E	<b>9E000044</b>	\$1,817.00
S680/S690/S780/S790	400 + 75 bu.	2012-2023	7" Tall	MS75E	<b>9E000049</b>	\$2,552.00
S780/S790	400 + 75 bu.	2023 & Newer	7" Tall		<b>9E000065</b>	\$2,552.00
<i>* Aftermarket hydraulic cylinder included: 9E-49 and 9E-65</i>						
X9-1000	420 + 180 bu.				<b>9E000063</b>	\$1,968.00
X9-1100	460 + 140 bu.				<b>9E000064</b>	\$1,236.00
<b>CASE IH FACTORY POWER FOLD EXTENSION</b>						
7120, 7230, 7240, 7250 (24" panels)	315. + 75 bu.		13" Tall	MZ315P	<b>9E000050</b>	\$3,162.00
<b>Handrail Options at no charge:</b>						
<i>R5E000163LO -Required for CIH 7120</i>						
<i>R5E000193LO Required for CIH 7240</i>						
<i>OEM Handrail will work on CIH 7230</i>						
8120, 9120, 7230, 8230, 9230 (27" panels)	350 + 75 bu.		13" Tall	MZ350P	<b>9E000051</b>	\$3,319.00
7240, 8240, 9240, 7250, 8250, 9250 (34" rear panels) HR Optional	410 + 65 bu.		6" Tall	MX410P	<b>9E000054</b>	\$2,475.00
<b>CASE IH FACTORY POWER FOLD COVER EXTENSION</b>						
7120, 7230, 7240, 7250 (24" front/rear panels)	315 + 75 bu.		13" Tall	MZ315C	<b>9E000052</b>	\$2,984.00
<b>Handrail Options at no charge:</b>						
<i>R5E000163LO -Required for CIH 7120</i>						
<i>R5E000193LO Required for CIH 7240</i>						
<i>OEM Handrail will work on CIH 7230</i>						
8120, 9120, 7230, 8230, 9230 (27" panels)	350 + 75 bu.		13" Tall	MZ350C	<b>9E000053</b>	\$3,304.00
7240, 8240, 9240, 7250, 8250, 9250 (34" rear panels) HR Optional	410 + 65 bu.		6" Tall	MX410C	<b>9E000055</b>	\$2,316.00
<b>CASE NEW HOLLAND FACTORY POWER FOLD EXTENSION</b>						
CR6.80, CR6.90, CR7.90	315 + 75 bu.		13" Tall	MZ315P	<b>9E000050</b>	\$3,162.00
<b>CASE NEW HOLLAND FACTORY POWER FOLD COVER EXTENSION</b>						
CR8.90, CR9.90, CR10.90	410 + 65 bu.		6" Tall	CNH MZ410C	<b>9E000056</b>	\$2,316.00

**NOTE:** All capacities are based on level full



# DEMCO XL EXTENSIONS

Save time and increase productivity while harvesting with the Demco **XL** Extension/Tip-up

## STANDARD FEATURES

- Convenient fold down for storage or transport
- Durable and sturdy design
- Total capacity 560 bu
- Height above cab approx. 33"
- Overall height approx. 15'-6"

**Largest Extension/Tip-up on the market!**

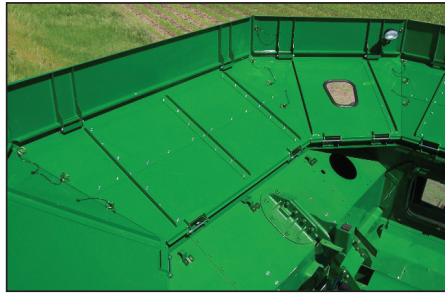

**HOW TO ORDER:** 1. Choose **Correct Part Number** 2. Determine **Extension Size** 3. Review **Accessories**

### JOHN DEERE

JD-XL (S680/S690/S780/S790)

**9E000040**

\$7,213.00

### CASE IH - CNH

Case IH 8010, 8120, 9120, 8230, 9230, 8240, 9240, 8250, 9250  
CNH CR980, CR9080, CR9090, CR8080, CR8090, CR8.90, CR9.90

**9E000042**

\$7,209.00

#### Handrail Options at no charge:

Case IH 8010

**R5E000164L0**

Case IH 8240/9240/8250/9250

**R5E000193L0**

Case IH 8120/9120/8230/9230

**R5E000163L0**

CNH CR8080/CR9080/CR6090/7090/8090/9090

**R5E000233L0**

CR6.80/6.90/7.90/8.90/9.90/10.90

**NOTE: All capacities are based on level full**



Demco Grain Tank Tip-ups are vertical panels that add to either the Demco Grain Tank Extension or to the factory OEM extension for added bushel capacity

Demco Grain Tank Extension replaces the factory extension for added bushel capacity and lower clearance of the combine

# DEMCO EXTENSIONS

Demco Grain Tank Extensions allow you to add more capacity by *replacing* the factory extension



## STANDARD FEATURES

- 3" formed channel frame provides unmatched strength and stability
- Rear entry step for added safety and convenience on Generation II extensions
- Corner caps on all Generation II extensions to prevent leakage
- Quick and easy fold down of extension for lower transport height

## JOHN DEERE

### ADDED BUSHEL CAPACITY PER EXTENSION

MODEL	ORIGINAL CAPACITY	EXTENSION	TIP-UP	TOTAL LEVEL CAPACITY
9400W, 9410W, 9450W	182 bu.	9E000003 - 300 bu.	9E000004 - 50 bu.	350
9500W, 9510W, 9550W	204 bu.	9E000003 - 300 bu.	9E000004 - 50 bu.	350
9550W, 9560W (2002 and Newer)	204 bu.	9E000008 - 300 bu.	9E000004 - 50 bu.	350
9600W, 9610W, 9650W	240 bu.	9E000003 - 350 bu.	9E000004 - 40 bu.	390
9650W, 9660W (2002 and Newer)	240 bu.	9E000009 - 350 bu.	9E000010 - 40 bu.	390
STS Series	300 bu.	9E000001 - 375 bu.	9E000002 - 60 bu.	435
S Series with Std. Rate Unload	250 bu.	9E000033 - 375 bu.	9E000034 - 60 bu.	435
S Series with High Rate Unload	300 bu.	9E000032 - 375 bu.	9E000002 - 60 bu.	435

**HOW TO ORDER:** 1. Choose **Correct Part Number** 2. Determine **Extension Size** 3. Review **Accessories**

JD 9400, 9410, 9450W (Prior to Serial # 695101) - <b>Extension</b>	<b>9E000003</b>	\$2,814.00
JD 9450W (Serial # 695101 and up) - <b>Extension</b>	<b>9E000008</b>	\$2,865.00
JD 9500, 9510, 9550W (Prior to Serial # 695201) - <b>Extension</b>	<b>9E000003</b>	\$2,814.00
JD 9550, 9560W (Serial # 695201 and up) - <b>Extension</b>	<b>9E000008</b>	\$2,865.00
JD 9600, 9610, 9650W (Prior to Serial # 695301) - <b>Extension</b>	<b>9E000003</b>	\$2,814.00
JD Walker 9400-9500-9600 Series - <b>Tip-up</b>	<b>9E000004</b>	\$1,093.00
JD 9650, 9660W (Serial # 695301 and up) - <b>Extension</b>	<b>9E000009</b>	\$2,865.00
JD 9650, 9660W (Serial # 695301 and up) - <b>Tip-up</b>	<b>9E000010</b>	\$1,093.00
JD 96/9750, 96/97/9860, 96/97/9870 STS - <b>Extension</b>	<b>9E000001</b>	\$3,355.00
JD 96/9750, 96/97/9860, 96/97/9870 STS - <b>Tip-up</b>	<b>9E000002</b>	\$1,200.00
*JD STS (Required for High Rate Unloading Auger) - <b>Mounting Kit</b>	<b>9E000017</b>	\$460.00
*JD STS (Additional Corner Filler Strips, NOT Required) - <b>Mounting Kit</b>	<b>9E000031</b>	\$131.00
JD S Series with HIGH RATE UNLOADING AUGER - <b>Extension + Mounting Kit</b>	<b>9E000032</b>	\$3,840.00
JD S Series (Use with part # 9E000032) - <b>Tip-up</b>	<b>9E000002</b>	\$1,200.00
JD S Series with STANDARD RATE UNLOADING AUGER - <b>Extension</b>	<b>9E000033</b>	\$3,416.00
JD S Series (Use with part # 9E000033) - <b>Tip-up</b>	<b>9E000034</b>	\$1,222.00

**NOTE:** All capacities are based on level full



# DEMCO EXTENSIONS

## STANDARD FEATURES

- 3" formed channel frame provides unmatched strength and stability
- Rear entry step for added safety and convenience on Generation II extensions
- Corner caps on all Generation II extensions to prevent leakage
- Quick and easy fold down of extension for lower transport height



## CASE-IH

### ADDED BUSHEL CAPACITY PER EXTENSION

MODEL	ORIGINAL CAPACITY	EXTENSION	TIP-UP	TOTAL LEVEL CAPACITY
7010, 7120, 7230, 7240, 7250	315 bu.	9E000015 - 365 bu.	9E000016 - 70 bu.	435
All 8000/9000 Series	330 bu.	9E000015 - 365 bu.	9E000016 - 70 bu.	435
60-66 SERIES BLACK	185 bu.	9E000011 - 290 bu.	9E000012 - 45 bu.	335
80-77-88 SERIES BLACK	210 bu.	9E000011 - 305 bu.	9E000012 - 45 bu.	350
LEGACY SERIES	300 bu.	9E000057 - 300 bu.	9E000058 - 75 bu.	375

**NOTE: Demco Extension will not fit a CIH 2588**

**HOW TO ORDER:** 1. Choose **Correct Model Number** 2. Determine **Extension Size** 3. Review **Accessories**

CIH 60, 80, 66, 77, 88 Series Black (60/66/reqs riser) - <b>Extension</b>	<b>9E000011</b>	\$3,050.00
CIH 60, 80, 66, 77, 88 Series Black - <b>Tip-up</b>	<b>9E000012</b>	\$1,093.00
CIH 60/66 - <b>Riser Kit</b>	<b>9E000007</b>	\$399.00
CIH 7010/8010, 7120/8120/9120, 7230/8230/9230 Black - <b>Extension</b>	<b>9E000015</b>	\$3,355.00
CIH 7010/8010, 7120/8120/9120, 7230/8230/9230 Black - <b>Tip-up</b>	<b>9E000016</b>	\$1,200.00
CIH Legacy Series - <b>Extension</b>	<b>9E000057</b>	\$3,355.00
CIH Legacy Series - <b>Tip-up</b>	<b>9E000058</b>	\$1,200.00

## NEW HOLLAND

### ADDED BUSHEL CAPACITY PER EXTENSION

MODEL	ORIGINAL CAPACITY	EXTENSION	TIP-UP	TOTAL LEVEL CAPACITY
CR920	205 bu.	9E000015 - 315 bu.	9E000016 - 70	385
CR940, 9040	255 bu.	9E000015 - 365 bu.	9E000016 - 70	435
CR960, 9060	300 bu.	9E000015 - 365 bu.	9E000016 - 70	435
CR970, 9070	330 bu.	9E000015 - 365 bu.	9E000016 - 70	435
CR6090, 7090, 8080	315 bu.	9E000015 - 365 bu.	9E000016 - 70	435
CR9080, 8090, 9090	350 bu.	9E000015 - 365 bu.	9E000016 - 70	435

**HOW TO ORDER:** 1. Choose **Correct Model Number** 2. Determine **Extension Size** 3. Review **Accessories**

NH CR920, 940, 960, 970, 9040/60/70/80, 60/70/80/9090, 8080 - <b>Extension</b>	<b>9E000015</b>	\$3,355.00
NH CR920, 940, 960, 970, 9040/60/70/80, 60/70/80/9090, 8080 - <b>Tip-up</b>	<b>9E000016</b>	\$1,200.00

**NOTE: All capacities are based on level full**

# AUGERS AND EXTENDERS™

## BIN FILL AUGER

- Available to fit most makes and models of combines
- Reduces auger flighting wear, relieves belts, pulleys, clutches, chains and gear boxes
- Set screws allow for infinite adjustment to maximize grain holding capacity
- Quick release pivot to lower to transport position in seconds
- Mounting brackets attach easily to your grain tank



Bin Fill Auger (does <b>NOT</b> include hoses!)	<b>9A000013</b>	\$2,030.00
<i>Please note combine size for proper length of support pipe</i>	<b>5A000013</b>	N/C
BFA Auger Extender 2010 (adds 16" in height of auger)	<b>9A000051</b>	\$183.00
Flow Control Valve (w/ built in relief valve)	<b>1AKFADD0000</b>	\$321.00
Check Valve (required on CIH combine w/ hydraulic reverser)	<b>1AKGANGANGO</b>	\$118.00
Flat Face Hydraulic Fitting Kit	<b>97961000</b>	\$61.00

## SPOUT RE-DIRECT KIT

- Spout mounts on to factory spout and directs the grain downward
- Ideal for small grains, swathing, short header, windy conditions and low grain truck or wagon applications as well



Case and New Holland	<b>9A000058</b>	\$393.00
John Deere - 17" High Capacity	<b>9A000069</b>	\$725.00



# COMBINE UNLOADING AUGER EXTENDER

**The Extender** is a Trade Mark of Stewart Steel Inc. and is manufactured in Canada by Stewart Steel Inc.

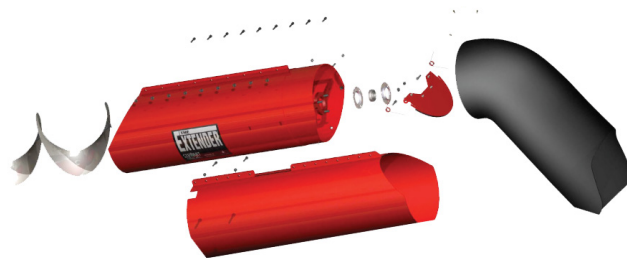

PART NUMBER	COMBINE MODELS	LENGTH	PRICE
<b>CASE AXIAL FLOW 1440-2588</b>			
9A000017	1440, 1460, 1480, 1640, 1660, 1680, 1644, 1666, 1688, 2144, 2166, 2188, 2344, 2366, 2388, 2577, 2588	36"	\$1,853.00
<b>CASE (CIH) 2004-2011</b>			
9A000023	7010 & 8010 from 2003-2006 Black 14" Auger	36"	\$1,853.00
9A000043	5088, 6088, 7088, 7120, 8120, 9120, 7230, 8230, 9230, Red w/14" Auger	36"	\$1,853.00
R1A000034	7010 & 8010 from 2007-2008 Red Auger	36"	\$1,930.00
R1A000033	7010 & 8010 from 2007-2008 Black Auger	36"	\$1,930.00
9A000056	8230, 9230 w/High Capacity Unloading 16" Auger	24"	\$2,003.00
9A000070	CIH w/ High Capacity and Actuator Spout - Red	24"	\$6,075.00
9A000071	CIH w/ High Capacity and Actuator Spout - Black	24"	\$6,075.00
<b>NEW HOLLAND YELLOW</b>			
9A000026	TR87, TR88, TR89, TR97, TR98, TR99, TX66, TX68	24"	\$2,077.00
<b>NEW HOLLAND CNH</b>			
9A000023	CR840, CR940, CR960, CR970, CX840, CX860 2003-2006 CR9040, CR9060, CR9070, CR9080, CR9090, CX9040, CX9060 2009-2014	36"	\$1,853.00
R1A000033	CR840, CR940, CR960, CR970, CX840, CX860 for 2007-2008		\$1,930.00
9A000066	9090, 9080 w/High Capacity Unloading 16" Auger	24"	\$1,866.00
<b>JOHN DEERE</b>			
9A000018	6620, 7720, 8820, 9400, 9500, 9600, CTS, 9510, 9610, 9550, 9650, 9750 w/13" Auger	36"	\$1,780.00
9A000064	9560, 9660, 9760, 9570, 9670, T670, S-Series w/14" Auger	28"	\$2,532.00
9A000034*	9760, 9860, 9770, 9870, S-Series w/17" Auger	36"	\$3,116.00
* Not recommended if combine is equipped w/ folding auger			
<b>MASSEY</b>			
9A000020	All Massey Rotaries up to 9790 - <b>SPECIAL ORDER</b>	36"	\$2,077.00
9A000044	9520, 9540, 9560, 9695, 9795, 9895 w/15" Auger	42"	\$3,264.00
9A000057	9520, 9540, 9560 w/16" Auger	42"	\$2,881.00
9A000065	9520, 9540, 9560 w/15" Auger - Newer Models	42"	\$2,997.00
<b>GLEANER</b>			
9A000024	Series L, N to R w/12" Auger - <b>SPECIAL ORDER</b>	24"	\$2,077.00
9A000030	Series N to 66, R76, S67, S77, S96, S97, S98 w/14" Auger	24"	\$1,781.00
9A000045	A65, A75, A85, A66, A76, A86 w/15" Auger - <b>SPECIAL ORDER</b>	42"	\$2,997.00
<b>CATERPILLAR</b>			
9A000020	Challenger Models w/12" Auger - <b>SPECIAL ORDER</b>	36"	\$2,077.00

# SPECIAL INFORMATION

## PRICES & SPECIFICATIONS

All prices and specifications are subject to change without notice. All shipments are billed at price prevailing at time of shipments. ALL PRICES F.O.B. BOYDEN OR SPENCER, IOWA OR AS DESIGNATED IN THIS CATALOG.

## TERMS

Customers desiring credit must have good rating or furnish satisfactory reference before shipment will be made, otherwise all orders will be shipped C.O.D. No cash discounts allowed with C.O.D. shipments.

## ORDERING

Prospective customers requesting open account status will be required to complete a Demco credit application. If open terms cannot be approved, other means of payment will be considered. Please furnish a completed Demco credit application with your first order.

## SHIPMENTS

Our merchandise is carefully packed and thoroughly inspected before leaving our factory. Responsibility for its safe delivery is assumed by the carrier upon acceptance of the shipment. Claims for loss or damage sustained in transit must therefore be made upon the delivering carrier as follows:

**CONCEALED LOSS OR DAMAGE** - Concealed loss or damage means loss or damage which does not become apparent until the merchandise has been unpacked. The contents may be damaged in transit due to rough handling even though the carton may not show external damage. When the damage is discovered upon unpacking, make a written request for inspection by the carrier's agent within 15 days of the delivery date. Then file a claim with the carrier, since such damage is the carrier's responsibility.

**VISIBLE LOSS OR DAMAGE** - Any external evidence of loss or damage must be noted on the freight bill or express receipt, and signed by the carrier's agent. Failure to adequately describe such external evidence of loss or damage may result in the carrier refusing to honor a damage claim. The form required to file a claim will be supplied by the carrier.

## SHIPPING ERRORS

Shipping errors resulting in shortages or goods ordered incorrectly by the customer, must be reported to Demco Mfg. within 10 days after receipt of merchandise.

## PICK UP ORDERS

All orders picked up and signed for by the customer or customer's agent at the Boyden or Spencer, Iowa plants are considered complete as signed. Customer will receive a copy of signed order at time of loading.

## PARCEL POST, U.P.S., FEDERAL EXPRESS & FREIGHT

Due to the special packing and handling on Parcel Post and United Parcel shipments, a combined shipping and handling fee will be charged on each carton. Weight limitations are as follows:

Parcel Post = 70 lbs.

UPS = 150 lbs.

Federal Express = 150 lbs. - per carton.

A pallet charge is added on all freight orders.

## RETURNS

NO GOODS ARE TO BE RETURNED WITHOUT A RETURNED GOODS AUTHORIZATION NUMBER AND INVOICE NUMBER. When your order has been filled correctly, the concerned party returning goods must in all cases pay freight, the cost of handling and a 25% restocking charge. All goods to be returned are to be in first class condition. Additional charges will be made for goods returned in other than first class condition.



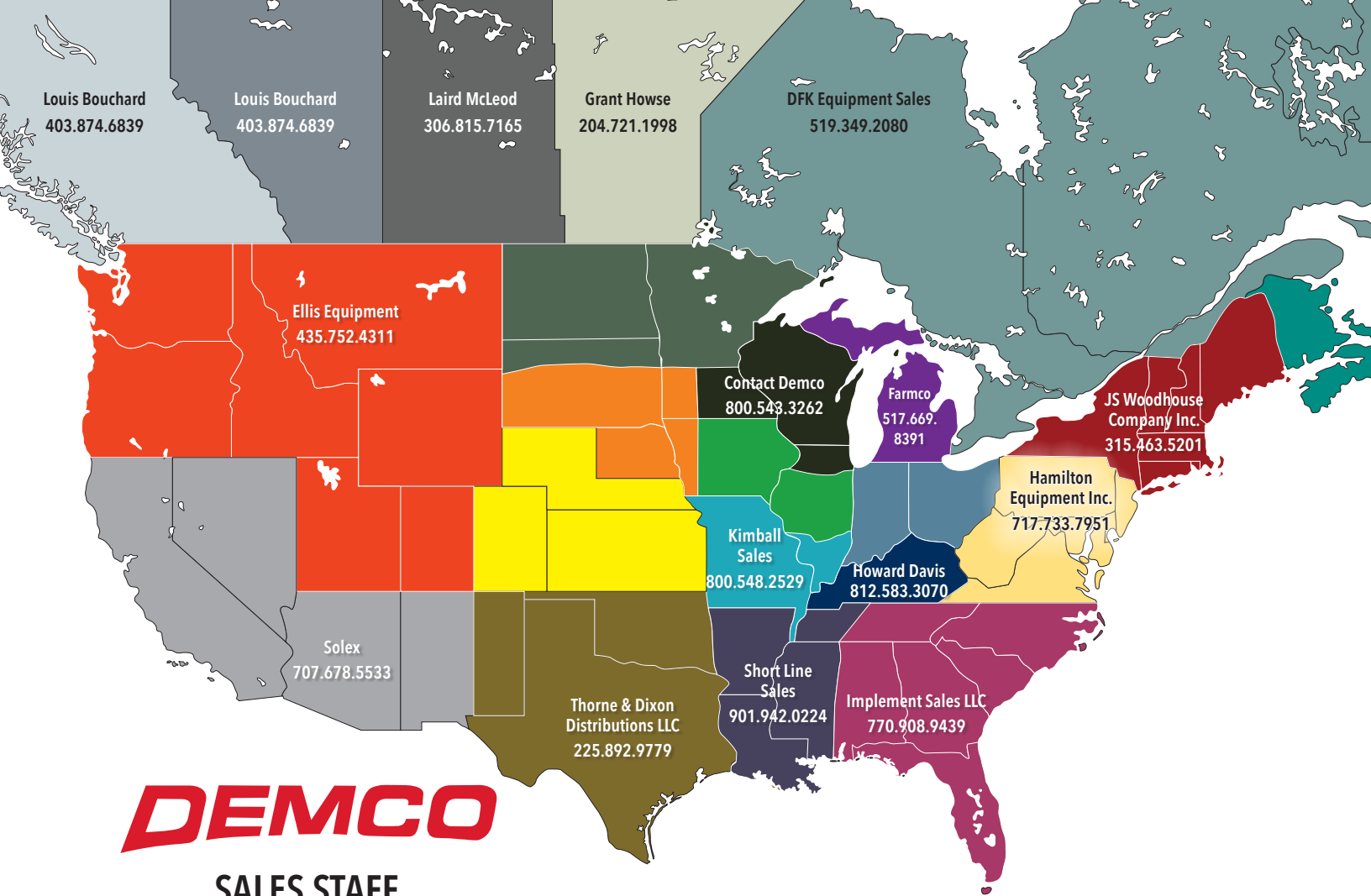

# DEMCO

## SALES STAFF



**Chris Currans**

(515) 708-1147  
[chris.currans@demco-products.com](mailto:chris.currans@demco-products.com)



**Jordan Fulsebakke**

(701) 970-9611  
[jordan.fulsebakke@demco-products.com](mailto:jordan.fulsebakke@demco-products.com)



**Mike Niska**

(517) 204-3887  
[mike.niska@demco-products.com](mailto:mike.niska@demco-products.com)



**Brian Tonniges**

(308) 390-1400  
[brian.tonniges@demco-products.com](mailto:brian.tonniges@demco-products.com)



**Derrik Netten**

(319) 415-9790  
[derrik.netten@demco-products.com](mailto:derrik.netten@demco-products.com)

